

Product Description

Light antique wall light with matt black shade

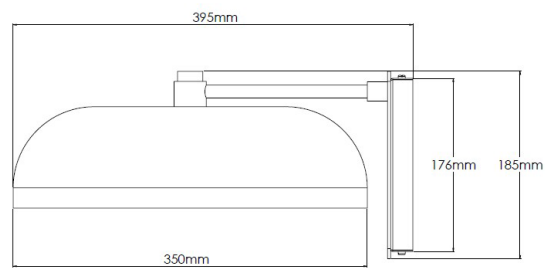

Technical Specification

MATERIAL	Mild Steel	IP Rating	IP20
FINISH	Light Antique P2/LAQ	HEIGHT	185mm
LAMPHOLDER TYPE	Large G9	WIDTH	350mm
RECOMMENDED LAMP	G9 Only	DEPTH/PROJECTION	395mm
MAX WATTAGE	9W	BACK/CEILING PLATE	175x85mm
CERTIFICATIONS	UKCA CE	BASE DIAMETER	N/A
DIMMABLE	Mains - If lamps are compatible	WEIGHT	6kg
CLASS I / II / III	Class I	SHADE MATERIAL	Metal